

# Dopmoeren Ecrous borgnes

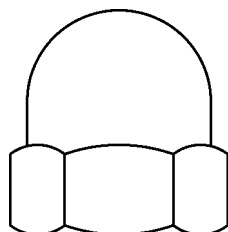
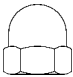

DIN 1587  
ISO/EN 1618

			INOX A2		
Afmeting Dimension	verpakking emballage	kg/1000 kg/1000	code code	Bef/100 Fb/100	Euro/100 Euro/100
M 4	200	1,70	1587IN004	610	15,12
M 5	200	2,06	1587IN005	610	15,12
M 6	200	4,66	1587IN006	677	16,78
M 8	200	11,00	1587IN008	942	23,35
M 10	100	20,10	1587IN010	1.770	43,88
M 12	100	28,30	1587IN012	2.692	66,73
M 14	50	41,90	1587IN014	6.250	154,93
M 16	50	54,30	1587IN016	7.608	188,60
M 18	25	95,00	1587IN018	15.858	393,11
M 20	25	104,00	1587IN020	16.548	410,21
M 24	10	216,00	1587IN024	32.568	807,34

**lasmoeren**  
**Ecrou à souder**

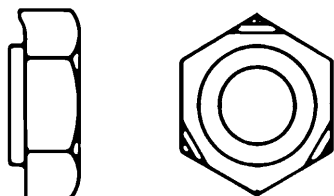

DIN 929  
 ISO/EN

			INOX A2		
Afmeting Dimension	verpakking emballage	kg/1000 kg/1000	code code	Bef/100 Fb/100	Euro/100 Euro/100
M 4	1000	1,13	929IN004	260	6,45
M 5	1000	1,73	929IN005	390	9,67
M 6	500	2,50	929IN006	510	12,64
M 8	500	5,27	929IN008	700	17,35
M 10	200	9,58	929IN010	990	24,54
M 12	200	13,70	929IN012	1.920	47,60
M 14	100	21,30	929IN014	4.900	121,47
M 16	100	28,50	929IN016	5.800	143,78

# Zeskantmoeren

## Ecrou hexagonal

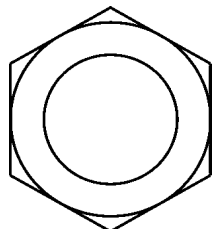

DIN 934  
ISO/EN 4032

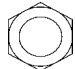
			INOX A2		
Afmeting Dimension	verpakking emballage	kg/1000 kg/1000	code code	Bef/100 Fb/100	Euro/100 Euro/100
M 3	500	0,38	934IN003	42	1,04
M 4	250	0,81	934IN004	49	1,21
M 5	250	1,23	934IN005	54	1,34
M 6	250	2,50	934IN006	78	1,93
M 8	250	5,20	934IN008	160	3,97
M 10	200	11,60	934IN010	345	8,55
M 12	100	17,30	934IN012	538	13,34
M 14	100	25,00	934IN014	780	19,34
M 16	100	33,30	934IN016	1.030	25,53
M 18	50	49,40	934IN018	1.650	40,90
M 20	50	64,40	934IN020	2.080	51,56
M 22	50	79,00	934IN022	2.650	65,69
M 24	50	110,00	934IN024	5.980	148,24
M 27	50	165,00	934IN027	11.880	294,50
M 30	25	223,00	934IN030	12.920	320,28

## Zelfborgende zeskantmoer met kunststof ring Ecrou auto-freine hexagonal avec anneau plastique

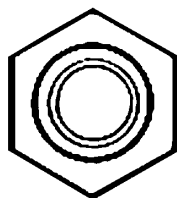

DIN 985  
ISO/EN

			INOX A2		
Afmeting Dimension	verpakking emballage	kg/1000 kg/1000	code code	Bef/100 Fb/100	Euro/100 Euro/100
M 3	200	0,50	985IN003	74	1,83
M 4	200	1,00	985IN004	95	2,35
M 5	200	1,40	985IN005	120	2,97
M 6	200	2,40	985IN006	138	3,42
M 8	200	5,10	985IN008	240	5,95
M 10	100	10,60	985IN010	430	10,66
M 12	100	17,20	985IN012	697	17,28
M 14	100	26,00	985IN014	1.362	33,76
M 16	50	34,00	985IN016	1.490	36,94
M 18	50	45,00	985IN018	8.380	207,73
M 20	50	65,00	985IN020	5.987	148,41
M 24	50	100,00	985IN024	15.616	387,11

**Vleugelmoeren Amerikaans model**  
**Ecrou à oreilles - model américaine**

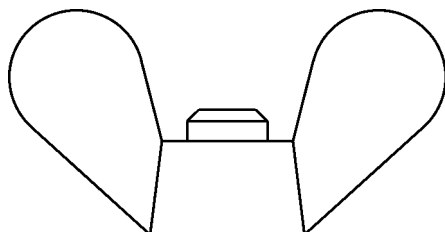

ISO/EN

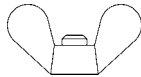
			INOX A2		
Afmeting Dimension	verpakking emballage	kg/1000 kg/1000	code code	Bef/100 Fb/100	Euro/100 Euro/100
M 5	250	2,80	VMIN005	635	15,74
M 6	200	4,80	VMIN006	820	20,33
M 8	100	10,20	VMIN008	1.120	27,76
M 10	100	21,20	VMIN010	1.482	36,74
M 12	50	34,40	VMIN012	4.220	104,61